



Plot 4, 46 Salisbury Road, Hoddesdon, EN11 0HY

• 60% NOW SOLD • These beautifully appointed four-bedroom homes with 1363 sq² of living accommodation and with 10-year NHBC warranty are located within a 5-minute walk to Rye House Station, where Tottenham Hale and London Liverpool Street can be directly accessed. • 60% NOW SOLD • Each of these stunning homes offers south facing gardens with river side views along with off street parking for two vehicles, electric car charging point and double-glazed sash windows. The ground floor accommodation has an impressive entrance hall with porcelain tiled floor, leading to the carpeted and

Key features

- 60% NOW SOLD •
- South Facing Gardens with River Aspect
- Located only 5 Minute Walk to Rye House Station
- Spacious Family Bathroom with Hansgrohe Sanitaryware
- A Collection of Beautifully Appointed Four Bedroom Homes, with 1363 Sqft of Living Accommodation
- Off Street Parking and Electric Car Charging Point

Property Information

Tenure

Freehold

Council Tax

EPC Rating

Local Authority

Broxbourne Borough Council

Lease Length

Service Charge & Ground Rent

TBC



hoddesdon@paulwallace.co.uk

01992 466471







Ground Floor

Approx. 51.2 sq. metres (551.3 sq. feet)

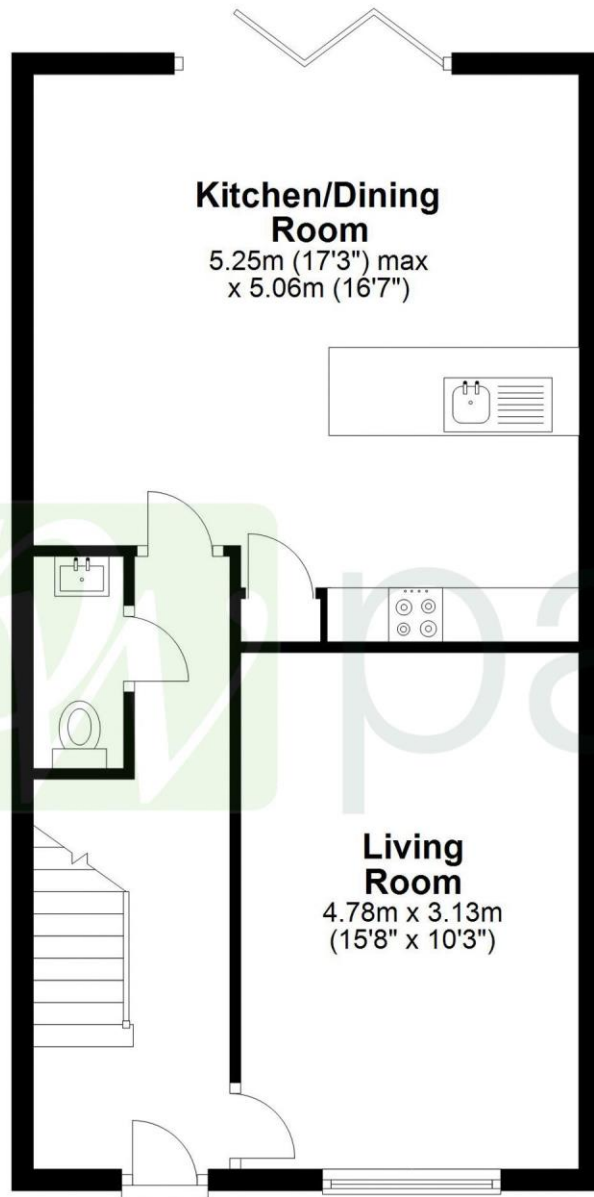

First Floor

Approx. 46.6 sq. metres (501.8 sq. feet)

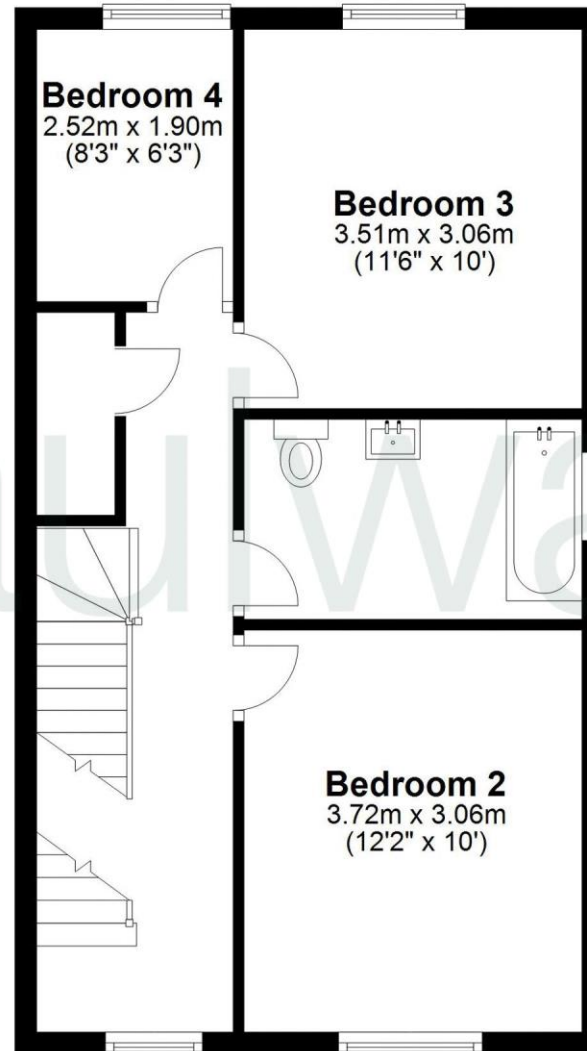

Second Floor

Approx. 28.8 sq. metres (309.8 sq. feet)



Total area: approx. 126.6 sq. metres (1362.9 sq. feet)

FOR ILLUSTRATIVE PURPOSES ONLY. NOT TO SCALE

Whilst every attempt has been made to ensure the accuracy of the floor plan shown, all measurements, positioning, fixtures, features, fittings and any other data shown are an approximate interpretation for illustrative purposes only and are not to scale. No responsibility is taken for any error, omission, miss-statement or use of data shown.

Property marketing provided by www.matthewkyle.co.uk

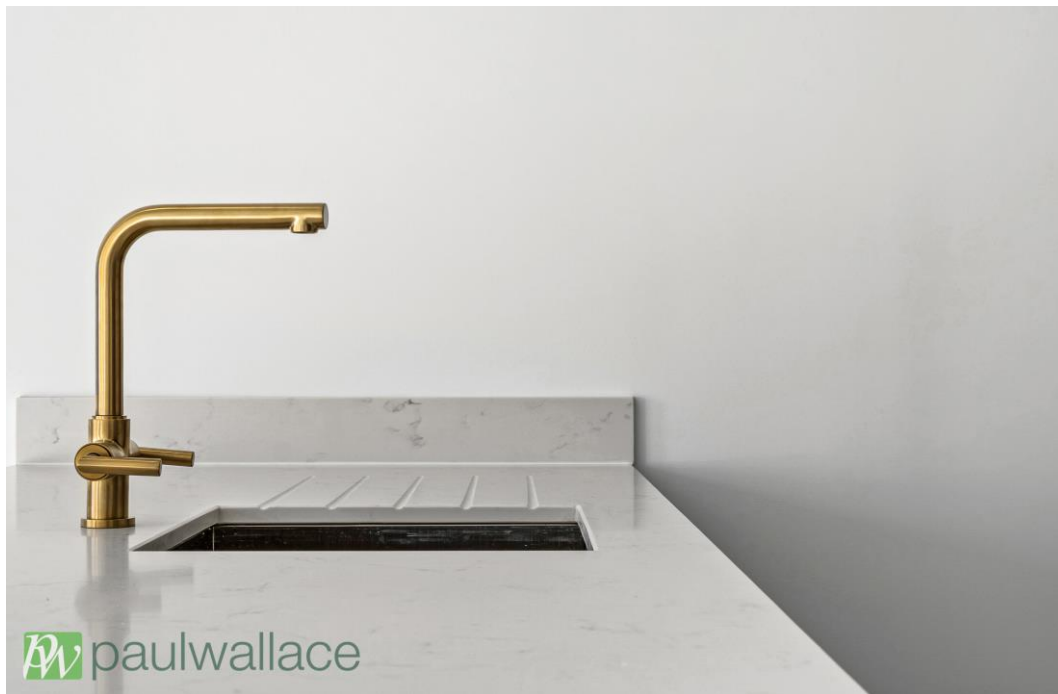





Paul Wallace Estate Agents

70 High Street
Hoddesdon
Hertfordshire
EN11 8ET



01992 466471



hoddesdon@paulwallace.co.uk



www.paulwallace.co.uk



Opening Times

Mon	9am to 6.30pm
Tues	9am to 6.30pm
Wed	9am to 6.30pm
Thurs	9am to 6.30pm
Fri	9am to 6.30pm
Sat	9am to 5.00pm
Sun	Closed



paulwallace
estate agents

Agents Note: Whilst every care has been taken to prepare these sales particulars, they are for guidance purposes only. All measurements are approximate and are for general guidance purposes only and whilst every care has been taken to ensure their accuracy, they should not be relied upon. Potential buyers are advised to recheck the measurements.